



Under Construction!



Summer Camp 2026

We are excited to welcome your camper to another amazing summer at Mt. Hood Kiwanis Camp! As many of you know, we will begin construction on a major new building this year. While this project will help us expand and improve our programs in the future, it will also create some temporary but important changes to how camp is organized this summer.

Due to construction, we will only be able to use CY Lodge for indoor camper housing. This means that Hemlock and Laurel will be closed for the 2026 season, and our traditional camper group layout will look different.



Camper Housing

We will **still** have 7 total camper groups.

- 4 groups will be housed in CY Lodge (3 groups downstairs & 1 upstairs).
- 1 group will stay in the Yurt.
- 1 group will stay in the Platform Tents.
- 1 group will be up upper Barlow (G group)

To ensure safety, comfort, and accessibility, campers must be able-bodied and independent with ADLs to be placed in the Upstairs Cy and Platform Tent groups.

Bathroom & Shower Access:

To support group needs, we will be adding extra porta potties. The Yurt and Platform Tent groups will use the Pool House for morning and evening routines and showers.

GENDERED GROUPS

All the groups in CY Lodge will be the same gender (male or female) and the Yurt & Platform tent groups will be the same gender (male or female).

G Group will remain co-ed.

Tents

If your camper typically sleeps in a personal tent on a dorm porch, we will not be able to accommodate that sleeping arrangement this year due to limited space.

Please talk to your camper about the other lodging spaces available.

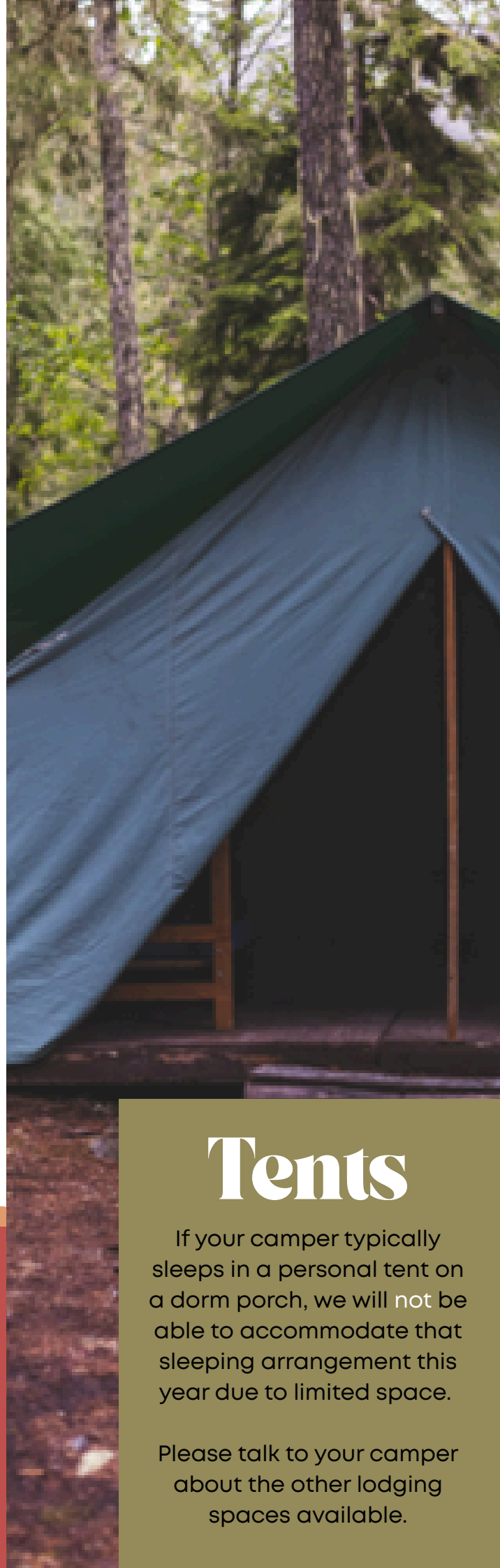



Program Areas

You can expect all the camper favorites—fishing, horses, adventure, arts & crafts, and the pool—to continue as usual. Some programs will shift spaces due to construction:

- No biking program this summer
- Art will take place at the picnic tables in the field
- Recreation will move to the field
- There will be a viewing area of the construction site while campers are at fishing or free time.

Check-In & Out

Check-In:

Next summer, all camper check-in will take place **from the road**. Families will park along the road and walk in with their camper's belongings. Our check-in table and nursing station will be located in the field at the picnic tables. We will have extra volunteers to assist with this process.

*Accessible parking will be available behind Fanning only for those who need it.

Check-Out:

Check-out will run as a **drive-up car line behind Fanning**. Campers will be waiting in the field and will walk to their car once their ride arrives.

Thank you for being patient and courteous as we navigate this adjusted process!





Eligibility

Our eligibility standards will remain the same.

However, due to using only one lodge this season and having **very limited accessible space**, we can only accommodate a ***smaller number of campers who require full care.***

This includes campers who utilize a wheelchair or other mobility devices, and campers who require a medical bed.

We want to be transparent so families can plan ahead, and we appreciate your understanding as we work within these temporary space limitations.

Caregivers

Due to space limitations in the lodge this season, we will only have room for ***one camper who requires a caregiver per week.***

If your camper typically attends with a caregiver, we may be able to accommodate additional caregiver-supported campers if the caregiver and camper are willing to sleep in a personal recreation tent outside the main building.

For campers who typically come with a caregiver and apply for camp in 2026, you will be contacted before the lottery begins to discuss whether a tent accommodation is a possibility.



Enrollment

APPLICATION WINDOW:

February 2-13, 2026

All required paperwork must be filled out and submitted within the 2-week window to be eligible for the lottery.

*Behavior support plans must be submitted within the 2-week window.

MAIN CAMP	TUITION: \$1,161.25 ACTIVITY FEE: \$475.75 TOTAL: \$1,637	<ul style="list-style-type: none">• 1:1 camper/counselor ratio• Housed in lower Cy or Platform Tents• Uses bathrooms & showers in Cy
FOREST TREKKERS	TUITION: \$1,161.25 ACTIVITY FEE: \$475.75 TOTAL: \$1,637	<ul style="list-style-type: none">• 2:1 camper/counselor ratio• Housed in Upper Cy or the Yurt• Uses bathrooms & showers in Cy or Pool House
GROUND EXPLORERS	TUITION: \$1,161.25 ACTIVITY FEE: \$475.75 TOTAL: \$1,637	<ul style="list-style-type: none">• 2:1 camper/counselor ratio• Housed in Platform Tents at Upper Barlow• Uses bathrooms & showers at Pool House and portable toilets

Please read and understand that your campers' typical lodge may change!



Prepping for Camp: Resources

We know next summer will feel different for many campers—sleeping areas, program spaces, and routines will all look a little new.

To help with the transition, we'll share resources to help you prepare your camper.

These will be available in March.

- Social Stories
- Map of Camp
- Photo previews of the Yurt, Platform Tents, Pool House, and Cy Lodge.
- “What to Expect at Camp This Year” video
- Updated packing List

Get Ready for Camp: Live Q&A

We will be holding *live virtual Q & A sessions for campers and families* to get more information about enrollment and speak to the Executive Director, Programs Director, and Operations Directors directly.

Dates:

- **January 7th at 6:00-6:45pm**
- **January 14th at 12:30-1:15pm**
- **January 24th at 10:00-10:45am**

We will send all camper families a link in January to these sessions. Hop on whichever one works best for you!



NEW HEMILOCK

A new dorm will **increase MHKC's current camper capacity** by 50% and add enhanced accessibility features needed to give campers with developmental and physical disabilities an optimal camp experience.

For Oregonians, going to “the mountain” is a widely shared and treasured experience. Our overarching goal is to “Open the Mountain” for everyone to have that opportunity, even those who have faced the highest barriers based on disability.

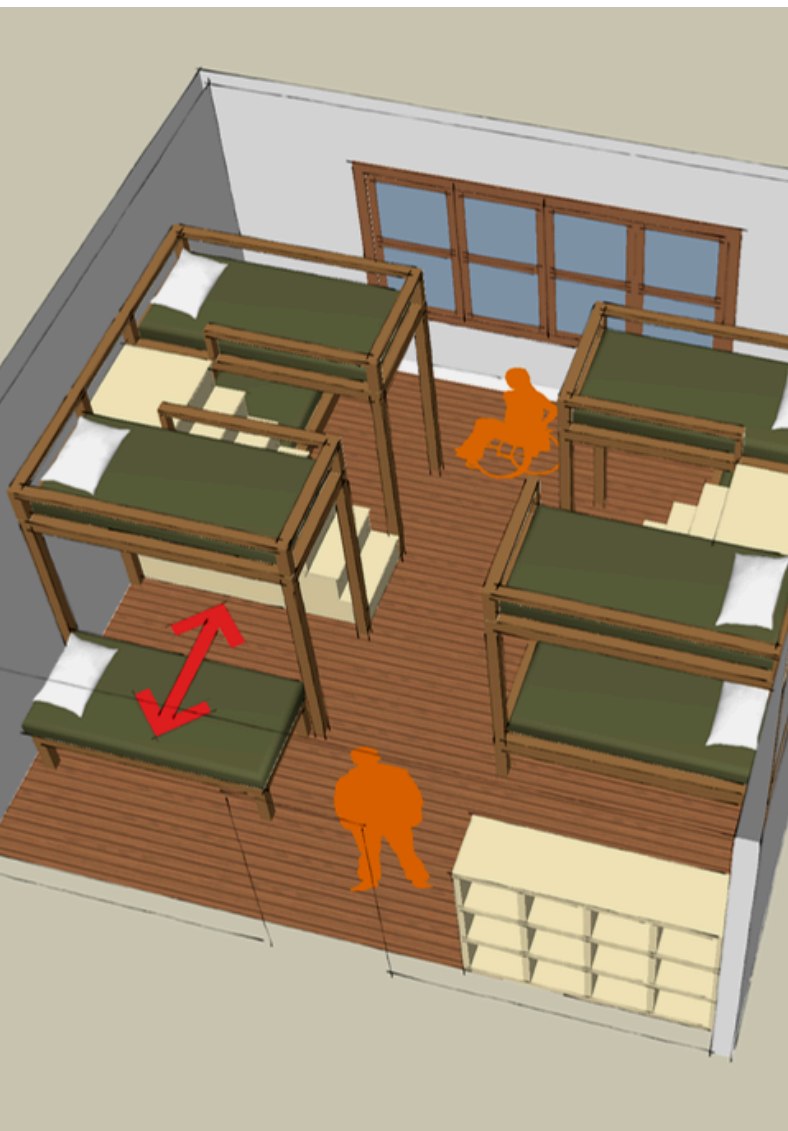
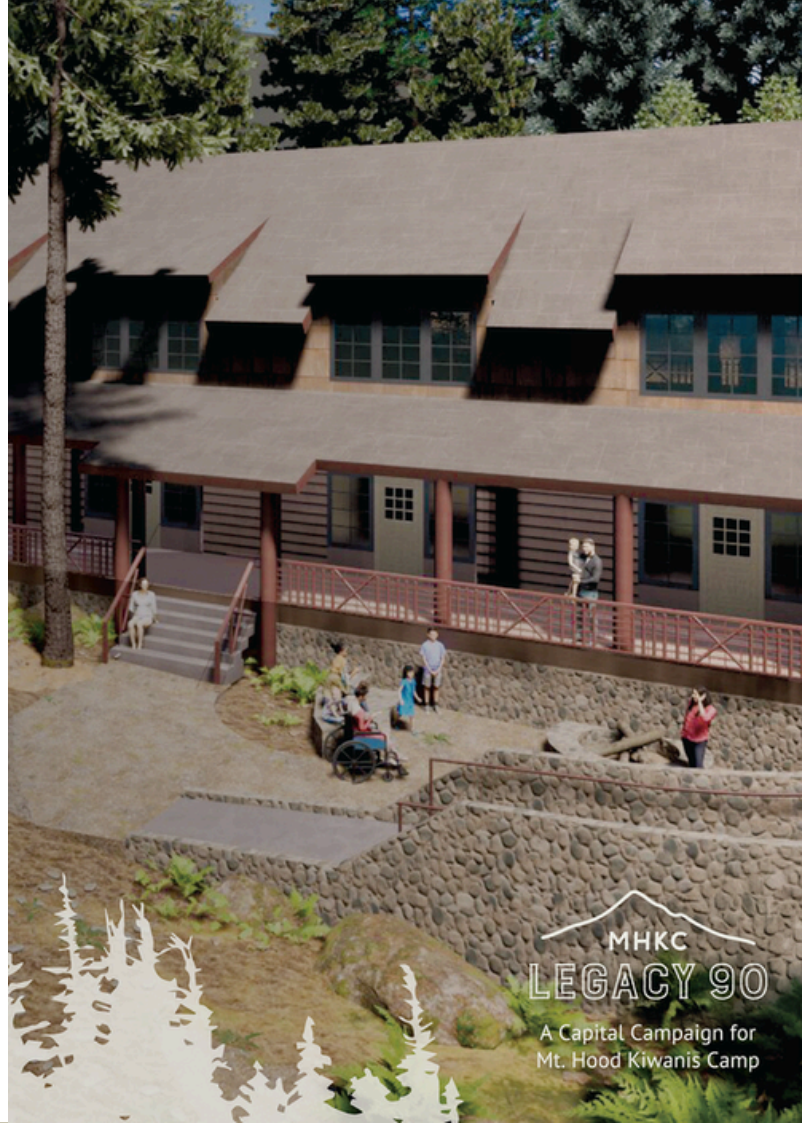

Accessible Bunks

Our new dorm will include **fully accessible bunk beds** to better support all campers, including those with physical disabilities. Right now, many campers can't safely use the top bunks because of vertical ladders and low ceilings, and some lower bunks make wheelchair transfers difficult.

In the New Hemlock:

- Staircases (not ladders) will lead to top bunks, making them safer and easier to access.
- Lower bunks will have a trundle-style design to allow smoother, safer transfers from wheelchairs.

Q & A

About the Construction

What's happening this summer?

Our Hemlock Dorm will be under construction as we build a new, fully accessible dorm. All campers will sleep in CY Lodge, the Yurt, or Platform Tents.

Will camp still happen?

Yes! Camp will run as usual. The construction area will be fenced off and safe.

Can we see the new building?

We'll share photos and updates online. Families can tour the new building once it's finished.

Safety & Noise

Is the construction area safe?

Yes. It will be completely fenced off and supervised. Campers will not go near it.

Will there be noise?

There may be daytime construction noise. We'll support campers with sensory needs using headphones, quiet spaces, and calming breaks. Please bring your own noise canceling headphones if you foresee this being a distraction for your camper.

Sleeping & Living Arrangements

Where will campers sleep?

We will still have 7 total camper groups.

- 4 groups will be housed in CY Lodge
 - 3 groups downstairs & 1 upstairs [F Group]
- 1 group will stay in the Yurt.
- 1 group will stay in the Platform Tents.
- 1 group will be up upper Barlow (G group)

To ensure safety, comfort, and accessibility, campers must be able-bodied and independent with ADLs to be placed in the Upstairs Cy and Platform Tent groups.

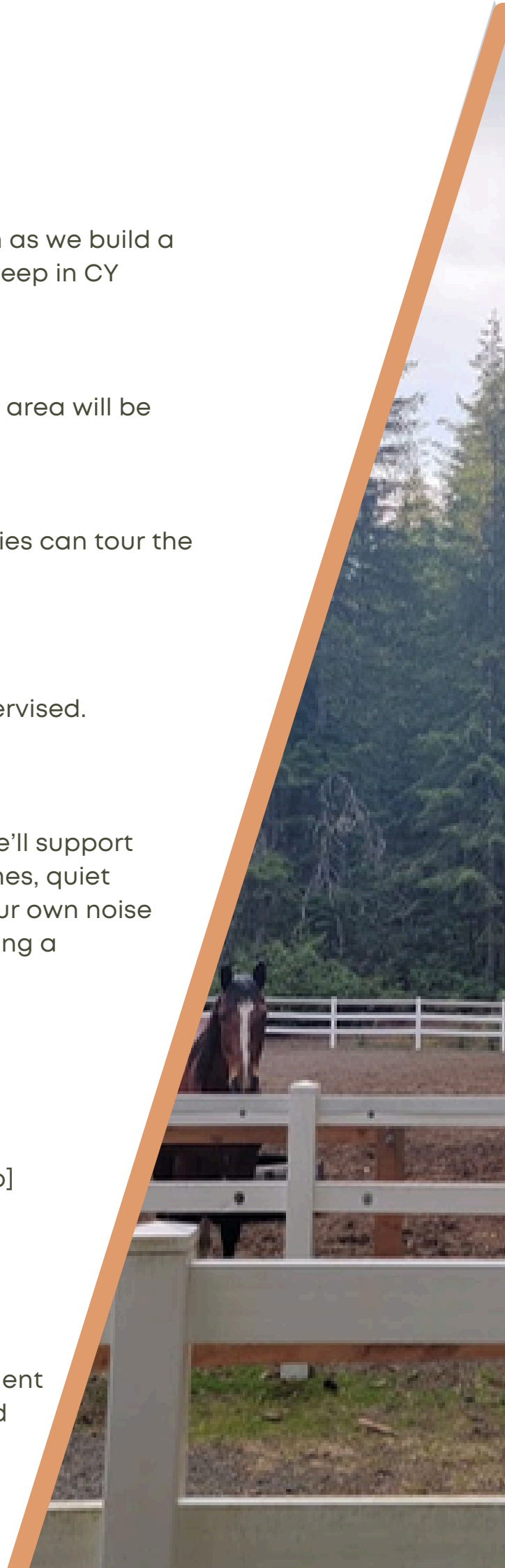

Will the groups in CY be Male or Female?

All the groups in CY Lodge will be the same gender (male or female) and the Yurt & Platform tent groups will be the same gender (male or female).

G Group will remain co-ed.

How will sleeping groups work?

Groups will still be based on camper needs, though some age mixes may vary. Staff will help campers adjust to new spaces.

Can my camper still sleep in a tent?

No. If your camper typically slept in a personal tent on the porch of Hemlock or in CY Lodge, we will NOT be able to accommodate that this summer due to limited housing space. Please talk with your camper about what the lodging spaces are and prep them that personal tents won't be available.

Will counselors and staff still be on night duty?

Yes. Night duty will remain the same. Two counselors or staff will be on duty each night per group. A director and a nurse will also still be on duty each night.

My camper has never been inside CY Lodge, the Yurt or Platform tents, how can I show them what their lodging might look like?

Check out our resources page here for pictures and videos of the buildings. There are also social stories and visuals to prep them for camp this summer.

My camper typically comes to Camp with a Caregiver; can the caregiver still attend?

Due to space limitations in the lodge this season, we will only have room for one camper who requires a caregiver per week.

If your camper typically attends with a caregiver, we may be able to accommodate additional caregiver-supported campers if the caregiver and camper are willing to sleep in a personal recreation tent outside the main building.

For campers who typically come with a caregiver and apply for camp in 2026, you will be contacted before the lottery begins to discuss whether a tent accommodation is a possibility.

Daily Activities

Will activities change?

No. Campers will still enjoy swimming, arts & crafts, adventure, karaoke, horses, recreation, fishing, dance, Staff Infection Band, and more.

- The only activity we won't have is adaptive bikes.
- Art will take place in the field at picnic tables.
- Recreation will move to the field.
- There will be a viewing area of the construction site while campers are fishing or having free time.

Will group schedules and routines stay the same?

Yes. We are keeping daily schedules as consistent as possible.

Drop-Off & Logistics

Will check-in and pick-up change?

Yes. **Check-In** will take place from the road. Families will park along the road and walk in with their camper's belongings. Our check-in table and nursing station will be located in the field at the picnic tables. We will have extra volunteers to assist with this process.

*Accessible parking will be available behind Fanning only for those who need it.

Check-Out will run as a drive-up car line behind Fanning. Campers will be waiting in the field and will walk to their car once their ride arrives.

Thank you for being patient and courteous as we navigate this adjusted process!

Can our family travel during our camper's week?

Because some campers may need extra help adjusting to the temporary changes, we recommend families stay within two hours of camp this summer.

Lottery, Refunds & Eligibility

Will there still be a lottery to get into camp?

Yes. Enrollment will look the exact same.

If my camper needs to leave early, do we get a refund?

No. Activity fees are only refunded if canceled at least one week before check-in for medical reasons.

Will there be a change in eligibility standards?

No. Our eligibility standards will remain the same.

However, due to using only one lodge this season and having very limited accessible space, we can only accommodate a smaller number of campers who require full care.

This includes campers who utilize a wheelchair or other mobility devices, and campers who require a medical bed.

We want to be transparent so families can plan, and we appreciate your understanding as we work within these temporary space limitations.

Preparing Your Camper

Will visuals or social stories be available?

Yes! We'll send maps, photos, and social stories to help campers understand what's new.

I have more questions. Who can I talk to?

We will be holding **live virtual Q & A sessions** for campers and families to get more information about enrollment and speak to the Executive Director, Programs Director, and Operations Directors directly.

Dates:

January 7th at 6:00-6:45pm

January 14th at 12:30-1:15pm

January 24th at 10:00-10:45am

We will send all camper families a link in January to these sessions. Hop on whichever one works best for you!

**Please respect that this is a lot of change not only for you but for MHKC staff as well. We would love for all your questions to be saved and brought to one of these sessions instead of over email.*

I'm a little worried about all this change, will my camper still have a great experience?

Absolutely. Our team is prepared to support all campers and provide a fun, meaningful, and safe camp week as always! Remember this is just for ONE summer, and then we will have a beautiful new building to replace the Hemlock Dorm!